

FOREST RIDGE PHASE II

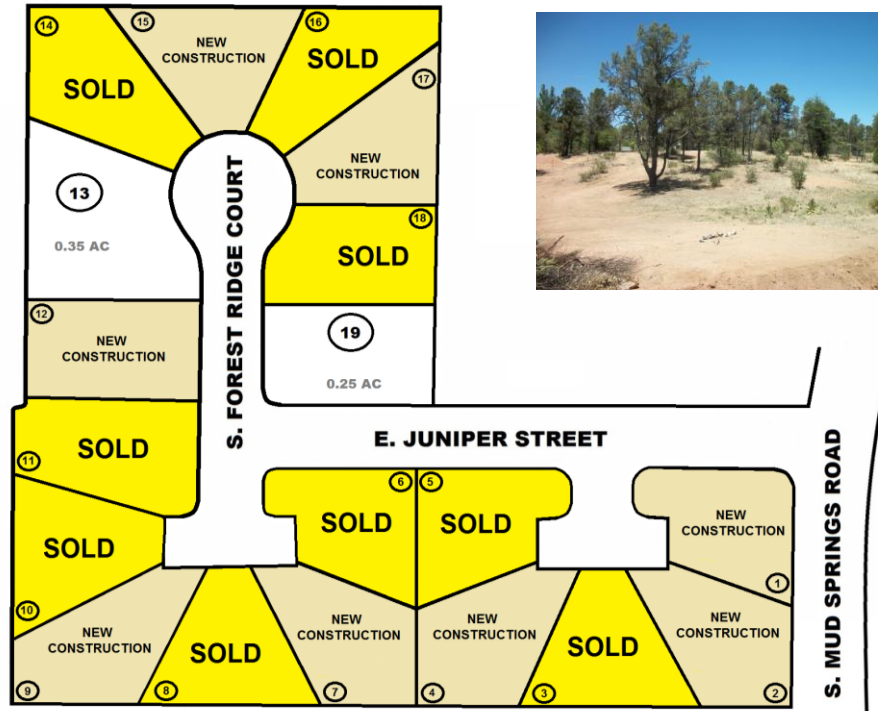

2 LOTS - \$60,000 & \$68,000
8 NEW BUILDS - \$290,000 TO \$350,000

Great opportunity to purchase a lot or a new home, in one of Payson's newest subdivisions. Nice level lots with trees. Located with easy access to Payson's shopping district.

PRICED TO SELL!!!

RORY HUFF

ERA® Young Realty & Investment
424 S. Beeline Highway
Payson, AZ 85541

Cell: (928) 595-0136

Email: roryhuff57@yahoo.com

Web: www.PaysonBestProperties.com

*Each ERA® office is independently owned and operated.
Information is deemed reliable but not guaranteed.*



Rory Huff
Associate Broker

FOREST RIDGE PHASE II

ACRES	LOT #	ADDRESS	PRICE*	MLS #
0.23	Lot 1	911 E. Juniper Street	NEW CONS	
0.23	Lot 2	909 E. Juniper Street	NEW CONS	
0.23	Lot 3	907 E. Juniper Street	SOLD	74258
0.24	Lot 4	905 E. Juniper Street	NEW CONS	
0.23	Lot 5	903 E. Juniper Street	SOLD	69796
0.23	Lot 6	409 S. Forest Ridge Court	SOLD	69797
0.23	Lot 7	411 S. Forest Ridge Court	NEW CONS	
0.23	Lot 8	414 S. Forest Ridge Court	SOLD	69799
0.25	Lot 9	412 S. Forest Ridge Court	NEW CONS	
0.23	Lot 10	410 S. Forest Ridge Court	SOLD	69801
0.27	Lot 11	408 S. Forest Ridge Court	SOLD	69803
0.26	Lot 12	406 S. Forest Ridge Court	NEW CONS	74666
0.35	Lot 13	404 S. Forest Ridge Court	\$60,000	69805
0.26	Lot 14	402 S. Forest Ridge Court	SOLD	74668
0.23	Lot 15	400 S. Forest Ridge Court	NEW CONS	74669
0.23	Lot 16	401 S. Forest Ridge Court	SOLD	74670
0.23	Lot 17	403 S. Forest Ridge Court	NEW CONS	74665
0.24	Lot 18	405 S. Forest Ridge Court	SOLD	69810
0.25	Lot 19	407 S. Forest Ridge Court	\$68,000	69811

**Price is correct at time of printing however subject to change.*